



# RIESENGEBIRGE

Landgasthof~Hotel~Restaurant  
~Biergarten~

Marktplatz 14  
90616 Neuhof an der Zenn

Tel: 09107 / 92441-0

Fax: 09107 / 92441-234

info@landgasthof-riesengebirge.de

www.landgasthof-riesengebirge.de

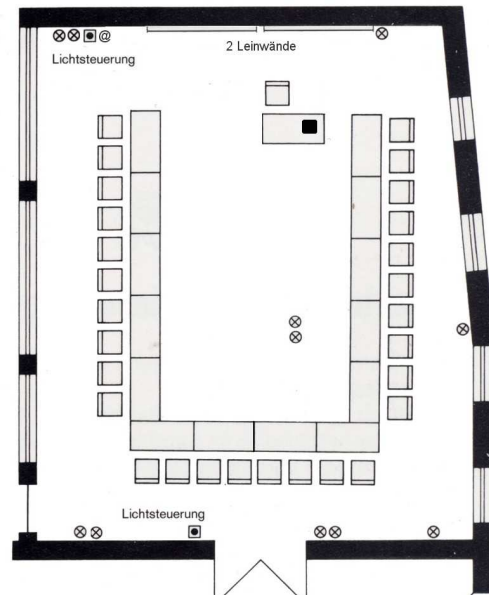

Frankensaal  
(bis 85 Personen) Verdunkelung, 93,4 m<sup>2</sup>,  
mit Blick ins Atrium, Lüftung, LAN, W-LAN

## Pausenzone

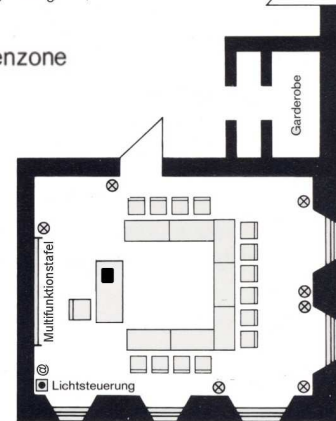



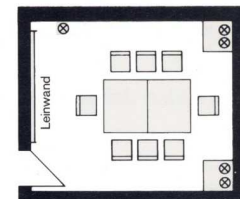

Parzifal  
(bis 24 Personen)  
Verdunkelung,  
Lüftung, W-LAN  
33,3 m<sup>2</sup>

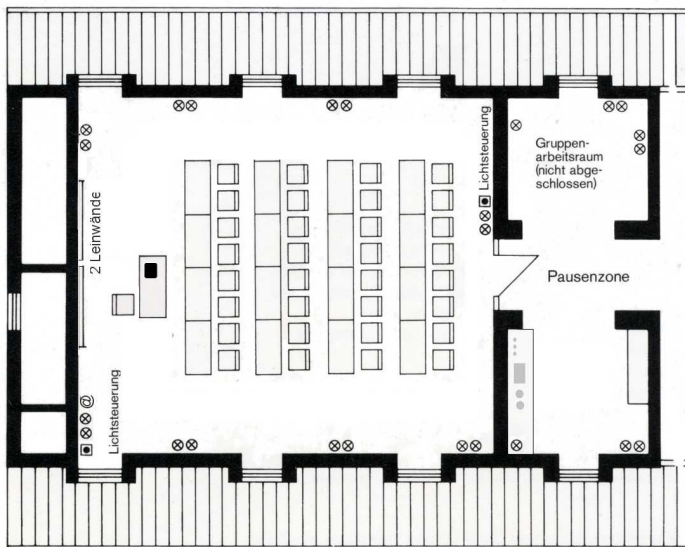

Vier Jahreszeiten  
(bis 8 Personen)  
18,3 m<sup>2</sup>, W-LAN  
kein Tageslicht,  
Lüftung

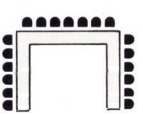
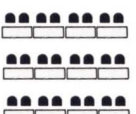
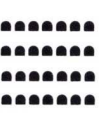

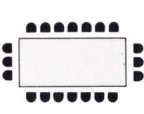
Peter Baude (bis 50 Personen), 75,8 m<sup>2</sup>, 2. Obergeschoß  
Verdunkelung, klimatisierbar, Lift vorhanden, Stauräume in den Dachschrägen  
LAN, W-LAN

	U-Form	Parlament	Kino	Stuhlkreis	Block	Inter-Aktion
Peter Baude						
Peter Baude	25	32	50	22	24	26
Frankensaal	30	50	85	30	24	50
Parzifal	14	18	24	10	16	16
Vier Jahreszeiten (ohne Tageslicht)	-	-	-	-	8	-